



maripoc



Gastro + CDI

maripoc Gastro

Norovirus GII.4

Norovirus GI

Rotavirus

Adenovirus

Campylobacter spp.

maripoc CDI

C. difficile GDH

C. difficile Toxin A/B

IDENTIFY *C. difficile* by detecting GDH

CONFIRM infection by detecting toxins A/B

BROADEN target coverage with the Gastro test

▶ **Run Gastro and CDI tests from the same sample!**



www.linkedin.fi/in/maripoc



www.twitter.com/ArcDialtd

ArcDia International Ltd.

www.maripoc.com



Made in Finland



mariPOC[®] gastro and CDI tests - best together!

The mariPOC[®] CDI test was developed to meet the ESCMID diagnostic guidance for *Clostridium difficile* infection (CDI). The mariPOC[®] CDI test simultaneously detects the gene expression of *C. difficile* specific GDH and the disease-causing toxins A and B in fecal specimens with high accuracy.

Furthermore, according to the guidance, patients with *C. difficile* toxin-negative results should have alternative diagnoses considered and tested. Increase the cost efficacy of patient management by broadening the detection from the same sample with mariPOC[®] gastro test panel!

ESCMID diagnostic guidance for *C. difficile* infection

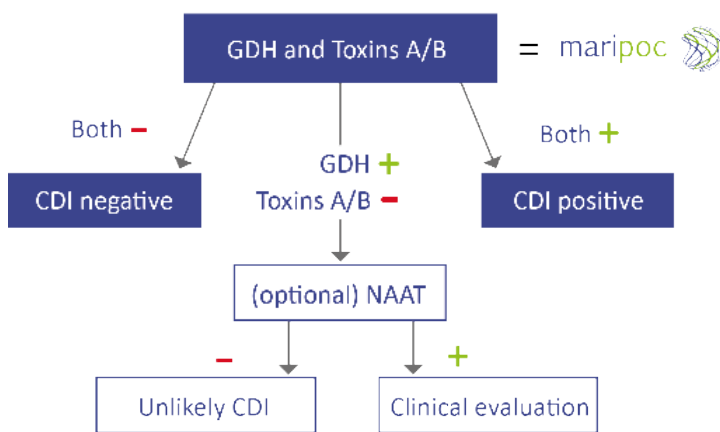

Result reporting:



20 min positives
2 h low positives and negatives

Performance

Method	Sensitivity	Specificity	N
mariPOC[®] CDI test			
<i>C. difficile</i> GDH	100%**	98.8%	188
<i>C. difficile</i> toxins A/B	>100%**	100%	188
mariPOC[®] gastro test			
Norovirus GII.4	100%*	99.5%	428
Norovirus GI	6 ng/mL	99.5%	428
Rotavirus	100%*	99.8%	651
Adenovirus	100%*	99.5%	651
Campylobacter spp.	>100%* 91% (culture)	97.5%	352

* immunochromatography

** membrane enzyme immunoassay

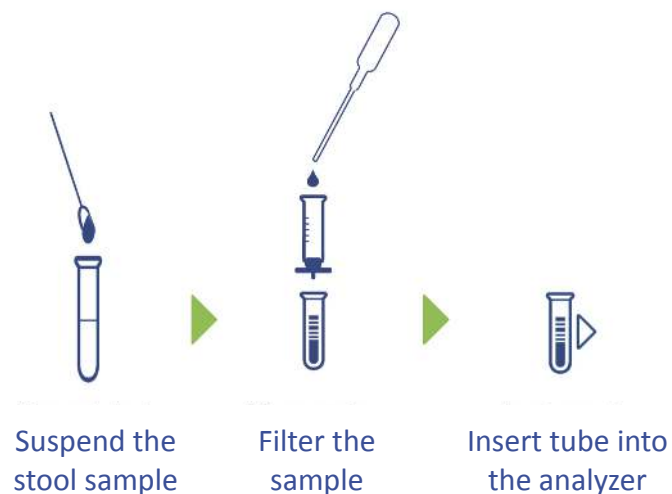

2019-03